

2010 Conference Program

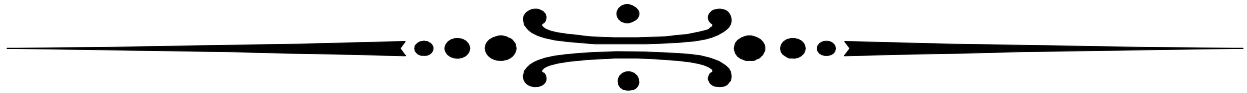

Mid-Continent Regional Science Association 41st Annual Conference

IMPLAN National User's Conference 8th Biennial Conference

June 3 – June 5, 2010

Hyatt Regency St. Louis at the Arch
St. Louis, Missouri

The Mid-Continent Regional Science Association

Officers

Aaron Lusby, Past President
Louisiana Tech University

Gisele Hamm, President
Western Illinois University

Russ Kashian, President Elect
University of Wisconsin - Whitewater

Ron Gunderson, Vice President and Chair, Student Paper Competition
Northern Arizona University

John Leatherman, Secretary/Treasurer
Kansas State University

Steve Deller, Representative to the North American Regional Science Council
University of Wisconsin - Madison

The Journal of Regional Analysis & Policy

Richard Cebula, Editor of JRAP
Jacksonville University

2010 Annual Meeting Program Committee

Russ Kashian, 2010 Program Committee Chair
University of Wisconsin - Whitewater

Gisele Hamm, 2010 Annual Conference Local Arrangements Co-Chair
Western Illinois University

Norm Walzer, 2010 Annual Conference Local Arrangements Co-Chair
Northern Illinois University

MCRSA / IMPLAN Program Schedule Overview

Thursday

3:00-5:30 **MCRSA Executive Committee** (open invitation)

6:00-8:30 **Registration and All Conference Reception**

Friday

7:30-10:30 **Registration**

8:00-8:20 **All Conference Welcome**

	MCRSA Breakout			IMPLAN Breakout
8:30-10:00	1a 1b 1c 1d			1e

10:00-10:30 **All Conference Break**

10:30-12:00	MCRSA Plenary		2a 2b
-------------	----------------------	--	----------

12:00-1:45 **All Conference Lunch, Awards, Speaker**

2:00-3:30	3a 3b 3c		3d 3e
-----------	----------------	--	----------

3:30-3:45 **All Conference Break**

3:45-5:15	4a 4b 4c 4d		4e 4f
-----------	----------------------	--	----------

Saturday

7:45-8:45 **All Conference Breakfast Buffet**

8:15 -8:45 **MCRSA Business Meeting – During Breakfast**

9:00-10:30	5a 5b 5c		IMPLAN Plenary
------------	----------------	--	-----------------------

10:45-12:15	6a 6b 6c		6d 6e
-------------	----------------	--	----------

12:15 p.m. **Conference Adjourns. Safe Travels!**

**2010 ANNUAL MEETING
PROGRAM**

THURSDAY, June 3, 2010

3:00 P.M. – 5:30 P.M.

MCRSA EXECUTIVE COMMITTEE MEETING

**– STERLING STUDIO 8
2ND FLOOR**

Open Invitation

6:00 P.M. – 8:30 P.M.

CONFERENCE WELCOME RECEPTION

**– GATEWAY EAST
18TH FLOOR**

Complementary hors d'oeuvres and cash bar.

FRIDAY, June 4

8:00 A.M. – 8:20 A.M.

CONFERENCE WELCOME

**– GRAND BALLROOM F
2ND FLOOR**

Gisele Hamm, President
Mid-Continent Regional Science Association

Scott Lindall, President
Minnesota IMPLAN Group, Inc.

FRIDAY, June 4

8:30 A.M. – 10:00 A.M.

MCRSA SESSION 1A: GROWTH POLICY

**– MILLS STUDIO 1
4TH FLOOR**

Chair: David Sorenson

Growth Hills and Optimal Government Spending: Location and Movement along the Curve

Author(s):

Viktor Khanzhyn, University of Nebraska-Lincoln (*presenting*)

Eric Thompson, University of Nebraska-Lincoln (*attending*)

David Rosenbaum, University of Nebraska-Lincoln (*non-attending*)

Political Objectives and Legal Strategies

Author(s):

Ragnild Vada, Nord-Trondelag University College, Norway (*presenting*)

The Determinants of Agglomeration in Health Sectors in US Cities

Author(s):

Bhawani P Mishra, University of Missouri (*presenting*)

Discussants:

David Sorenson

Rebekka Dudensing

Koichi Yamaura

FRIDAY, June 4

8:30 A.M. – 10:00 A.M.

MCRSA SESSION 1B: WIND ENERGY

**– MILLS STUDIO 2
4TH FLOOR**

Chair: Al Myles

Wind Development: Choosing the Site, Turbine and Blade Length

Author(s):

John Lehman, Appalachian State University (*attending*)

Quint David, Appalachian State University (*presenting*)

The Cost of Wind Energy: Comparing Distant Wind Resources to Local Resources

Author(s):

David Hoppock, Duke University (*presenting*)

Dalia Patiño-Echeverri, Duke University (*non-attending*)

Proposed Legislation Limiting Wind Development on the Mountains of North Carolina: The Economic and Policy Effects

Author(s):

John Lehman, Appalachian State University (*presenting*)

Discussants:

Al Myles

Shriniwas Gautam

Arne Kildengaard

FRIDAY, June 4

8:30 A.M. – 10:00 A.M.

MCRSA SESSION 1C: ENVIRONMENTAL ECONOMICS

**– MILLS STUDIO 4
4TH FLOOR**

Chair: Hanas Cader

Gateway Communities and Regional Amenity Resources

Author(s):

David Marcouiller, University of Wisconsin-Madison (*presenting*)

The Impact of Social Capital on Environmental Quality in Rural America

Author(s):

Ashleigh Arledge, University of Wisconsin-Madison (*presenting*)

The Role of Local Amenities in the Establishment of Small Businesses

Author(s):

Bjorn Markeson, University of Wisconsin-Madison (*presenting*)

Discussants:

Hanas Cader

Vardges Hovhannisyan

Elizabeth Johnston

FRIDAY, June 4

8:30 A.M. – 10:00 A.M.

**MCRSA SESSION 1D: PROPERTY TAXES AND HOUSING
– MILLS STUDIO 5
4TH FLOOR**

Chair: Sung Hoon Kang

Who Cares Who Collects? An Economic Analysis of Tax Liens Sales as a Method of Delinquent Property Tax Collection

Author(s):

Joshua Miller, University of Illinois at Chicago (*presenting*)

Property Taxation, Education Finance Reform, and Tax Base Growth

Author(s):

Mark Skidmore, Michigan State University (*attending*)

Laura Reese, Michigan State University (*non-attending*)

Sung Hoon Kang, Michigan State University (*attending*)

Real Estate Cycles, Supply and the Dynamics of Condominium Prices in Milwaukee Wisconsin

Author(s):

James Thorson, Southern Connecticut State University (*presenting*)

Discussants:

Sung Hoon Kang

Matthew Howell

Mark Skidmore

FRIDAY, June 4

8:30 A.M. – 10:00 A.M.

**IMPLAN SESSION 1E: ESTIMATING THE JOBS IMPACT OF THE
AMERICAN RECOVERY AND REINVESTMENT ACT (ARRA) OF
2009 USING IMPLAN AND OTHER INPUT OUTPUT TECHNIQUES
- GRAND BALLROOM F
2ND FLOOR**

**An Issue about Estimating the Jobs Impact from Government Program Expenditures
with an Input Output Multiplier Model**

Author(s):

Kenneth Hanson, U.S. Department of Agriculture (*presenting*)

**Estimating the Impact on Employment of USDA's Field Agency Programs in the
American Recovery and Reinvestment Act (ARRA)**

Author(s):

David Buland, U.S. Department of Agriculture (*presenting*)

**Estimating the Impacts on Employment of USDA's Forest Service Programs in the
American Recovery and Reinvestment Act (ARRA)**

Author(s):

Susan Winters, U.S. Department of Agriculture, Forest Service (*non-attending*)

Greg Alward, Minnesota IMPLAN Group, Inc. (*presenting*)

FRIDAY, June 4

10:00 A.M. - 10:30 A.M.

ALL CONFERENCE COFFEE BREAK

**- GRAND BALLROOM PRE-FUNCTION
4TH FLOOR**

FRIDAY, June 4

10:30 A.M. - 12:00 P.M.

**MCRSA PLENARY SESSION - GRAND BALLROOM F
4TH FLOOR**

Organizers: Gisele Hamm and Norm Walzer

**Economic Development Planning and Practice
in the Greater St. Louis Region**

Three St. Louis economic development professionals will present an overview of economic development planning and activities in the region. The panelist will describe how their organizations work together.

Ruth Sergenian, from the St Louis Regional Chamber & Growth Association (RCGA) will describe the RCGA's new economic development strategic plan. Research conducted for the RCGA by Market Street Services identified key industry cluster strengths and challenges. The regional plan, based on People, Prosperity and Place, provides direction for the region moving forward.

Karin Hagaman, of the St. Louis Development Corporation, will discuss current economic development initiatives underway in the City of St. Louis.

Douglas Rasmussen will describe St. Louis County as an economic driver for the State of Missouri. He will provide an overview of the Economic Council and describe how the Council helps companies. Doug will discuss the economy, commercial real estate, lending in the context of strengths, weaknesses, opportunities, and threats to the region.

Ruth Sergenian is the director of Economic Policy and Analysis at the St. Louis Regional Chamber and Growth Association. She has over 20 years of real estate market research and economic and community development consulting. Prior to joining the RCGA she was an analyst and project manager with RegionWise, a regional research center at Saint Louis University's School of Education and Public Service.

Karin Hagaman is a Major Project Manager with the St. Louis Development Corporation, the economic development organization for the City of St. Louis. In this role, she manages several multi-dimensional community economic development projects with significant City-wide impact. She has more than 10 years of experience in economic development.

Doug Rasmussen, vice president of business development for St. Louis County Economic Council, is responsible for the attraction, retention and expansion of business within St. Louis County. He has extensive experience in business development in both the public and private sectors. Rasmussen's responsibilities include negotiation of incentives for companies locating in St. Louis County and project management.

FRIDAY, June 4

10:30 A.M. – 12:00 P.M.

IMPLAN SESSION 2A: IMPLAN APPLICATIONS I

**– MILLS STUDIO 2
4TH FLOOR**

Impact of Base Realignment and Closing on the 11 County Region of North Carolina

Author(s):

Inder Nijhawan, Fayetteville State University (*presenting*)

**Economic Modeling Tool for Estimating Regional Economic Impacts of the Corps
Civil Works Programs**

Author(s):

Wen-Huei Chang, U.S. Army Corp of Engineers (*attending*)

Lisa McDonald, The Louis Berger Group (*non-attending*)

Holly Bender, The Louis Berger Group (*attending*)

David Moser, U.S. Army Corp of Engineers (*non-attending*)

**Using IMPLAN to Measure the Benefits of Community Farmers' Markets in
Mississippi**

Author(s):

Al Myles, Mississippi State University (*presenting*)

Ken Hood, Mississippi State University (*non-attending*)

FRIDAY, June 4

10:30 A.M. – 12:00 P.M.

IMPLAN SESSION 2B: USING IMPLAN

**– MILLS STUDIO 4
4TH FLOOR**

Emissions Factors for IMPLAN Models: an Application Using TEAM

Author(s):

Jared Creason, U.S. Environmental Protection Agency (*attending*)

Isabelle Morin, U.S. Environmental Protection Agency (*non-attending*)

Scott Moore, Moore Data, LLC (*attending*)

Linkalysis: Tools for Smart and Sustainable Economic Development

Author(s):

David Schoen, Ball State University (*attending*)

Nalitra Thaiprasert, Ball State University (*attending*)

**From Hours to Output: Getting Economic Impacts Right in Transportation
Investment Analysis**

Author(s):

Brian Alstadt, Economic Development Research Group (*presenting*)

Glen Weisbrod, Economic Development Research Group (*non-attending*)

FRIDAY, June 4

12:00 NOON - 1:45 P.M.

ALL CONFERENCE LUNCHEON & MCRSA AWARDS

**- GRAND BALLROOM E
4TH FLOOR**

Luncheon Speaker: Jack K. Strauss

What's Next for the Midwest: A "New Normal" or "Bimodal Economy?"

Professor Strauss is the Simon Chair of Economics at St. Louis University and Director of the Simon Center for Regional Forecasting. His experience in forecasting includes publications in top journals including Review of Financial Studies, Journal of Applied Econometrics, Journal of Portfolio Management, Econometric Reviews, Journal of International Forecasting, and Journal of Forecasting. Additional research includes more than a dozen publications in exchange rate determination including multiple articles in the Journal of International Money and Finance, Southern Economic Review, Review of International Economics, and Economic Letters on the subject. Professor Strauss further wrote for the Economist Intelligence Unit for several years including more than a dozen economic reports on Ukraine.

His background further includes international policy experience. He has consulted for the Central Bank of Azerbaijan, the Central Bank of Egypt, and the Ministry of Finance of Ukraine. For these government agencies, Professor Strauss modeled and forecasted the international macro-economy as well as trained their staff to implement these models. In Azerbaijan, for instance, his responsibilities included completion of a combination forecast model of both inflation and money demand that outperformed the autoregressive benchmark as well as their own models by more than 40%.

As director of the Simon Center, his responsibilities include organizing conferences for St. Louis University of the regional and national economy, forecasting the local economy of St. Louis and the State of Missouri and contributions to the media. He has been cited more than 150 times recently on local TV, radio, newspapers as well as national outlets including Wall Street Journal, U.S. News & World Report, Voice of America, and more.

FRIDAY, June 4

2:00 P.M. - 3:30 P.M.

MCRSA SESSION 3A: PRESIDENTIAL SYMPOSIUM

**- MILLS STUDIO 3
4TH FLOOR**

Chair: Russ Kashian, President-Elect

The foreclosure crisis of the last several years is an event of enormous concern to those who promote cities and develop neighborhoods. While healthy housing markets offer a basis for the life of a community, foreclosures often result in an abundance of negative externalities. The investment by families in housing offers an indication that there is confidence in the city's neighborhoods, business and communities. A housing market in crisis, on the other hand, prophesizes city in despair. It foretells of a city of diminishing tax bases and changes in the human makeup of neighborhoods. The papers contained in the Presidential Symposium examine the impact of foreclosures in a neighborhood and their impact on property values.

The Neighborhood Effect of Concentrated Condominium Sheriff Sales on Adjacent Condominium Values

Author(s):

Russ Kashian, University of Wisconsin-Whitewater

Exploring the Changes in Foreclosure Discounts from Saint Louis County, MO

Author(s):

William H. Rogers, University of Missouri at Saint Louis

Using Cluster Analysis to Understand Neighborhood response to Foreclosures: An Example from St. Louis

Author(s):

William Winter, University of Missouri at Saint Louis

FRIDAY, June 4

2:00 P.M. - 3:30 P.M.

MCRSA SESSION 3B: HUMAN CAPITAL

**- MILLS STUDIO 2
4TH FLOOR**

Chair: Dave Sorenson

Definitions of the Knowledge Concept and Its Usefulness in Regional Analysis

Author(s):

Hans Siggaard Jensen, University of Aarhus/Copenhagen Campus (*presenting*)

Job Satisfaction Amongst Knowledge Workers

Author(s):

Kjell Age Gotvassli, Nord-Trondelag University College, Norway (*presenting*)

Anne Sigrid Haugset, Trondelag Research and Development Institute, Norway
(*non-attending*)

Service Learning, Studio Teaching and Interdisciplinary Education: Reflections on Experience

Author(s):

Beth Walter Honadle, University of Cincinnati (*presenting*)

Discussants:

Dave Sorenson

Emily Kaye Seawright

Quint David

FRIDAY, June 4

2:00 P.M. - 3:30 P.M.

**MCRSA SESSION 3C: NATURAL DISASTERS AND ECONOMICS
- MILLS STUDIO 1
4TH FLOOR**

Chair: Eric Manthei

Social Disintegration During Times of Disease: An Examination of Disorder on Large Social Systems

Author(s):

Andrea Mason, Iowa State University (*presenting*)

Development and Application of a County Level Disaster Impact Model for the Texas Gulf Coast

Author(s):

Rebekka Dudensing, Texas A&M University (*presenting*)

James Richardson, Texas A&M University (*non-attending*)

Eric Manthei, Texas A&M University (*attending*)

Rural Community Recovery from Natural Disasters

Author(s):

Aaron Lusby, Louisiana Tech University (*presenting*)

Stephanie Tidwell, Louisiana Tech University (*non-attending*)

Discussants:

Eric Manthei

Charles Franklin

Bhawani P Mishra

FRIDAY, June 4

2:00 P.M. - 3:30 P.M.

IMPLAN SESSION 3D: IMPLAN APPLICATIONS II

**- MILLS STUDIO 4
4TH FLOOR**

Economic and Employment Opportunities from an Expanding Renewable Energy Sector

Author(s):

Burton English, The University of Tennessee (*presenting*)

Jamey Menard, The University of Tennessee (*non-attending*)

Kim Jensen, The University of Tennessee (*attending*)

Daniel G. De la Torre Ugarte, The University of Tennessee (*non-attending*)

Chad Hellwinckel, The University of Tennessee (*non-attending*)

Astronomical Impacts: A Methodology to Highlight the Contribution of a New Telescope over its Expected Life

Author(s):

John Eastwood, Northern Arizona University (*presenting*)

Wayne Fox, Northern Arizona University (*non-attending*)

Ronald Gunderson, Northern Arizona University (*attending*)

Economic Impact of Total Conversion to Dryland Agricultural Production on the Southern High Plains of Texas

Author(s):

Bridget Guerrero, Texas A&M University (*presenting*)

Andrew Wright, Texas Tech University (*non-attending*)

Darren Hudson, Texas Tech University (*non-attending*)

Stephen Amosson, Texas A&M University (*non-attending*)

Jeffrey Johnson, Texas Tech University (*non-attending*)

FRIDAY, June 4

2:00 P.M. - 3:30 P.M.

**IMPLAN SESSION 3E: AMENITIES AND ECONOMIC GROWTH
- MILLS STUDIO 5
4TH FLOOR**

The Economic Impact of Wildlife Associated Recreation Expenditures in Southeast US: A General Equilibrium Analysis

Author(s):

Anwar Hussain, Mississippi State University (*presenting*)

Ian Munn, Mississippi State University (*non-attending*)

David Holland, Washington State University (*non-attending*)

Stan Spurlock, Mississippi State University (*non-attending*)

An Economic Impact Analysis of Hunting Operations in South Texas

Author(s):

Erika Dodd, Texas A&M University (*presenting*)

Fred Bryant, Texas A&M University (*non-attending*)

Leonard Brennan, Texas A&M University (*non-attending*)

Barry Dunn, Texas A&M University (*non-attending*)

Charles Gilliland, Texas A&M University (*non-attending*)

Ronald Hy, Texas A&M University (*non-attending*)

Feasibility of Evaluating the Forward Linkages of US Army Corps of Engineers Business Lines

Author(s):

Lisa McDonald, The Louis Berger Group (*non-attending*)

Holly Bender, The Louis Berger Group (*attending*)

Wen-Huei Chang, U.S. Army Corp of Engineers (*attending*)

Dave Moser, U.S. Army Corp of Engineers (*non-attending*)

FRIDAY, June 4

3:30 P.M. – 3:45 P.M

ALL CONFERENCE COFFEE BREAK

**- GRAND BALLROOM PRE-FUNCTION
4TH FLOOR**

FRIDAY, June 4
3:45 P.M. – 5:15 P.M

MCRSA SESSION 4A: HUMAN CAPITAL & ECONOMIC GROWTH
– MILLS STUDIO 3
4TH FLOOR

Chair: Ron Gunderson

Linking Knowledge to Productivity

Author(s):

Knut Ingar Westeren, Nord-Trondelag University College, Norway (*presenting*)

The Regional and Statewide Impact of the California State University

Author(s):

Elizabeth Johnston, ICF International (*presenting*)

Economic Contribution of a Rural Texas Community College

Author(s):

Rebekka Dudensing, Texas A&M University (*presenting*)

Discussants:

Ron Gunderson

John Leatherman

Bjorn Markeson

FRIDAY, June 4
3:45 P.M. – 5:15 P.M

MCRSA SESSION 4B: ECONOMIC POLICY

– MILLS STUDIO 2
4TH FLOOR

Chair: Norm Walzer

Impact of Alternative Public Policy Options to Address Budget Shortfall in Louisiana

Author(s):

Aloyce R. Kaliba, Southern University and A&M College (*presenting*)
Donald Andrews, Southern University and A&M College (*non-attending*)
Ashagre Yigletu, Southern University and A&M College (*non-attending*)
David Bouras, Lincoln University (*non-attending*)

Pattern Analysis Highlighting Industry Patterns the Drive New Wealth in a Regional Economy

Author(s):

Alan Spell, Missouri Department of Economic Development (*presenting*)

The Economic Impacts of Increased Exports to Cuba: Contributing to the Policy Debate

Author(s):

Parr Rosson, Texas A&M University (*non-attending*)
Flynn Adcock, Texas A&M University (*non-attending*)
Eric Manthei, Texas A&M University (*presenting*)

Discussants:

Norm Walzer
Yue Zheng
Shahriar Kibriya

FRIDAY, June 4
3:45 P.M. – 5:15 P.M

MCRSA SESSION 4C: ECONOMIC IMPACTS

– MILLS STUDIO 1
4TH FLOOR

Chair: Gisele Hamm

The Economic Impact of Farm to School Lunch Programs: A Central Minnesota Example

Author(s):

Brigid Tuck, University of Minnesota Extension (*presenting*)

Robert King, University of Minnesota (*non-attending*)

Monica Haynes, University of Minnesota (*non-attending*)

Impact of Wal-Mart on the Structure of the Local Retail Sector

Author(s):

Stan Keil, Ball State University (*presenting*)

Lee Spector, Ball State University (*non-attending*)

Michael Hicks, Center for Business Research (*non-attending*)

Economic Impact of Irrigation Water Transfers in Uvalde County, Texas

Author(s):

Melissa Whited, University of Wisconsin-Madison (*presenting*)

Winner: M. Jarvin Emerson Student Paper Competition

Discussants:

Gisele Hamm

Joshua Miller

Bridget Guerrero

FRIDAY, June 4
3:45 P.M. – 5:15 P.M

MCRSA SESSION 4D: TAXATION AND PRICES

– MILLS STUDIO 4
4TH FLOOR

Chair: Russ Kashian

Effect of Gasoline Prices on Vehicle Miles Travelled: An Exploratory Analysis of Northern Virginia Traffic based on Granger Causality

Author(s):

Kingsley Haynes, George Mason University (*presenting*)

Rajendra Kulkarni, George Mason University (*non-attending*)

Roger Stough, George Mason University (*non-attending*)

The Impact of Tax and Expenditure Limits on City Credit Ratings

Author(s):

Steve Deller, University of Wisconsin-Madison (*attending*)

Judith Stallmann, University of Missouri (*non-attending*)

The Economic Impact of Property Tax Rate Limits: A Computable General Equilibrium Analysis

Author(s):

Nalitra Thaiprasert, Ball State University (*presenting*)

Dagney Faulk, Ball State University (*non-attending*)

Michael Hicks, Ball State University (*non-attending*)

Discussants:

Russ Kashian

Steve Vickner

Steve Deller

FRIDAY, June 4
3:45 P.M. – 5:15 P.M

IMPLAN SESSION 4E: GROWTH AND TECHNOLOGY
– MILLS STUDIO 5
4TH FLOOR

Measuring Broadband Internet Effects on Economic Outcomes

Author(s):

Hilal Atasoy, University of Illinois Urbana-Champaign (*presenting*)

Projected Economic Impacts of Green Jobs Development in the Appalachian Region

Author(s):

Kim Jensen, The University of Tennessee (*attending*)

Burton English, The University of Tennessee (*attending*)

Jamey Menard, The University of Tennessee (*non-attending*)

Dayton Lambert, The University of Tennessee (*non-attending*)

Economic Impact and Local Ownership: The Case of Minnesota Wind Power

Author(s):

Arne Kildengaard, University of Minnesota-Morris (*presenting*)

FRIDAY, June 4
3:45 P.M. – 5:15 P.M

IMPLAN SESSION 4F: TEACHING RURAL DEVELOPMENT
– MILLS STUDIO 7
4TH FLOOR

Chair: Aaron Lusby

A Private Sector View: Skill Requirements of IMPLAN Users

Author(s):

Greg Alward, Minnesota IMPLAN Group, Inc. (*presenting*)

Learning in High School Economics Courses: Explaining the Rural Achievement Gap

Author(s):

Eric Thompson, University of Nebraska-Lincoln (*presenting*)

Roger Butters, University of Nebraska-Lincoln (*attending*)

Carlos Asarta, University of Nebraska-Lincoln (*non-attending*)

FRIDAY, June 4 EVENING

WELCOME TO ST. LOUIS!

25 THINGS TO SEE AND DO IN ST. LOUIS

- Ride to the top of the Gateway Arch 630-feet over the Mississippi River.
- Visit an artistic oasis in the heart of downtown. Citygarden offers a vibrant blending of lush plantings and renowned sculpture.
- Explore Forest Park's 1,300 acres of lakes, walking paths and attractions.
- Drive Old Route 66 and visit some of the "Mother Road's" fascinating stops.
- Enjoy free attractions, including the Art Museum, Zoo, Science Center, Anheuser-Busch Brewery, Grant's Farm, and the Missouri History Museum.
- Marvel at the Missouri Botanical Garden, among the world's top public gardens.
- Free your inner child at the Magic House and City Museum.
- Visit an ancient Indian civilization at Cahokia Mounds.
- Cheer for Major League Baseball's St. Louis Cardinals.
- Count the mosaics at the breathtaking Cathedral Basilica of Saint Louis.
- Flirt with Lady Luck at one of the area's five casinos including: Lumière Place, Harrah's, The President, Ameristar and Casino Queen.
- Experience live blues music in one of the dozens of area clubs and taverns.
- Get your motor running at the Museum of Transportation or Gateway International Raceway.
- Visit the heart of St. Louis through our friendly and charming neighborhoods.
- Take in the art at the Laumeier Sculpture Park, the Contemporary Art Museum, the Pulitzer Foundation for the Arts and The Sheldon Concert Hall, Ballroom & Art Galleries.
- Discover American heritage at the Old Courthouse, Black World History Museum and Faust Historic Village.
- Visit the world-famous Budweiser Clydesdales at the Anheuser-Busch Brewery.
- Satisfy your taste buds at any of our hundreds of one-of-a-kind restaurants.
- Fill an extra suitcase during a shopping trip through major malls and antique and collectible stores.
- Attend one of the area's unique fairs or festivals.
- Explore the final frontier at the Science Center's Space Sciences Center or the Challenger Learning Center.
- Get an adrenaline rush on the world-class roller coasters and thrill rides at Six Flags St. Louis.
- Play Scott Joplin's ragtime tunes at the composer's historic home.
- Talk to the animals at Grant's Farm, Purina Farms, the Wild Canid Survival Center, the World Bird Sanctuary and the St. Louis Zoo.
- Cruise the mighty Mississippi River on the Tom Sawyer or Becky Thatcher paddle wheeler.

SATURDAY, June 5

7:45 A.M. - 8:45 A.M.

**ALL CONFERENCE BUFFET BREAKFAST AND
MCRSA BUSINESS MEETING**

**- GRAND BALLROOM E
4TH FLOOR**

All conference attendees are invited to the conference breakfast buffet and MCRSA business meeting

- Exchange of the gavel
 - State of the Association and business meeting
 - *Journal of Regional Analysis & Policy* update
-

SATURDAY, June 5

9:00 A.M. - 10:30 A.M.

MCRSA SESSION 5A: PRODUCTION FUNCTION I

**- MILLS STUDIO 3
4TH FLOOR**

Chair: Steve Deller

An Examination of Recent Migration to Arizona

Author(s):

Ronald Gunderson, Northern Arizona University (*attending*)

David Sorenson, Augustana College (*attending*)

The Impact of Levy Systems on the Economies and Agricultural Industries of Rural Communities in Louisiana

Author(s):

Aaron Lusby, Louisiana Tech University (*presenting*)

Margaret Hinton, Louisiana Tech University (*non-attending*)

Economic Impacts of Construction Activities, Residential Expenditures, and Collection of TIF Revenues Associated with Lake Oliver, Chatsworth, Livingston County, IL

Author(s):

Robin Hanna, Western Illinois University (*presenting*)

Discussants:

Steve Deller

Andrea Mason

Aaron Lusby

SATURDAY, June 5

9:00 A.M. - 10:30 A.M.

MCRSA SESSION 5B: REGIONAL ANALYSIS

**- MILLS STUDIO 2
4TH FLOOR**

Chair: John Leatherman

The New Economy: Will it Help or Leave Rural Areas Further Behind? Evidence from Kansas

Author(s):

Hanas Cader, American University of Kuwait (*attending*)

John Leatherman, Kansas State University (*attending*)

Agricultural Diversification in Iowa: Tracing Declines between 1950-2007

Author(s):

Sara Kaplan, Iowa State University (*presenting*)

Land Reform Policy in Agriculture, China

Author(s):

Yue Zheng, Kansas State University (*presenting*)

Discussants:

Russ Kashian

Stan Keil

John Leatherman

SATURDAY, June 5

9:00 A.M. - 10:30 A.M.

MCRSA SESSION 5C: ANALYTIC INSIGHT

**- MILLS STUDIO 4
4TH FLOOR**

Chair: Knut Ingar Westeren

A GIS based Spatial Healthcare Access Index for Missouri

Author(s):

Shriniwas Gautam, University of Missouri-Columbia (*presenting*)

**Componential Changes in the Food and Kindred Products Group Industry: A Class 1
Rail Carrier Origination Market Analysis**

Author(s):

Albert Myles, Mississippi State University (*presenting*)

Albert Allen, Mississippi State University (*non-attending*)

Saleem Shaik, North Dakota State University (*non-attending*)

Osei Yeboah, North Carolina A&T University (*non-attending*)

Financing Saint Louis Metro: The Impact of Proposition A

Author(s):

Sarah Markenson, St Louis University (*presenting*)

Discussants:

Knut Ingar Westeren

Arne Kildengaard

Melissa Whited

SATURDAY, June 5
9:00 A.M. - 10:30 P.M.

IMPLAN PLENARY SESSION 1:

- GRAND BALLROOM F
4TH FLOOR

IMPLAN Version 3.0

Scott Lindall, Minnesota IMPLAN Group, Inc.

Model Information

Model Year:	2007
Gross Regional Product:	\$6,421,722,800
Total Personal Income:	\$10,094,420,000
Total Employment:	92,018
Number of Industries:	219
Land Area (Square Miles):	392
Area Count:	1
Population:	226,475
Total Households:	84,403
Average Household Income:	\$119,598

Gross Regional Product

Value Added		Final Demand	
Employee Compensation:	\$3,743,281,000	Households:	\$7,976,920,000
Proprietor Income:	\$265,955,100	State/Local Government:	\$1,093,714,000
Other Property Type Income:	\$1,930,064,000	Federal Government:	\$229,474,400
Indirect Business Tax:	\$482,422,500	Capital:	\$934,484,800
		Exports:	\$5,260,987,000
		Imports:	(\$8,705,285,000)
		Institutional Sales:	(\$368,572,600)
Total Value Added:	\$6,421,723,000	Total Final Demand:	\$6,421,723,000

Economic Indicators

Shannon-Weaver Diversity Index: 0.69873

Top Ten Industries (View By: Employment)

Sector	Description	Employment	Labor Income	Output
413	Food services and drinking places	8,337	\$135,593,600	\$422,025,400
438	* Employment and payroll only (state & lo...	5,023	\$265,877,100	\$297,846,200
437	* Employment and payroll only (state & lo...	4,788	\$246,265,800	\$275,876,900
99	Wood windows and doors and millwork ...	3,425	\$300,812,400	\$870,637,600
394	Offices of physicians, dentists, and other ...	3,285	\$214,411,800	\$363,061,300
329	Retail Stores - General merchandise	3,174	\$64,980,600	\$146,470,500
360	Real estate establishments	2,336	\$47,675,640	\$310,782,900
425	Civic, social, professional, and similar org...	2,259	\$39,534,620	\$96,984,180
319	Wholesale trade businesses	2,220	\$171,475,700	\$444,007,400
324	Retail Stores - Food and beverage	2,192	\$59,862,060	\$128,801,500

Areas in the Model: Minnesota, Washington County

Your IMPLAN Model is constructed through the Regional Multipliers and is complete.

Scott will demonstrate the new features of IMPLAN Version 3 and talk about the development process. He will also introduce some future development plans for the IMPLAN system.

SATURDAY, June 5

9:00 A.M. - 10:30 P.M.

IMPLAN PLENARY SESSION 2:

- GRAND BALLROOM F 4TH FLOOR

Multi-Regional Input-Output (MRIO) Modeling with IMPLAN

Greg Alward, Minnesota IMPLAN Group, Inc.

IMPLAN V3 currently has the capability to link models of individual economies into MRIO networks of models that incorporate the commodity import supply-chain linkages between models. MRIO networks can have a geographic granularity as small as an individual county or any combination of counties. Sub-county network granularity is not available at this time, nor do the networks include income feedbacks.

Import trade flow linkages to build MRIO systems come from the IMPLAN Trade Flow Model. This formulated as a doubly-constrained gravity or entropy model estimated annually consistent with the annual IMPLAN data sets. IMPLAN trade flows are not currently available as a separate product.

Among options for solving an MRIO system MIG has chosen to partition the MRIO matrix into regional components and solve the system of simultaneous interactions numerically by iteration. As a practical matter, solution times rise exponentially as models are linked together. However, this maintains the most flexibility for users to create custom MRIO networks.

There are many benefits of to be gained from using MRIO networks for impact analysis. Among them is the ability to be explicit about the geographic distribution of impacts which allows for the obvious links to GIS. It also incorporates the asymmetric trade flows of the economic landscape such as those between metropolitan trade centers and hinterland areas. MRIO also demonstrates the role of trade feedbacks in the composition of multipliers.

Some interesting findings have arisen in early applications of MRIO modeling. For example, comparisons of impact results between an MRIO network and both single-region or pairs of single-region models of the same economy (they differ) demonstrate the role of direct-effect component of multipliers. On this point, MRIO networks offer clear and logically superior answers. In a practical sense, the ability to link very small geographic areas into an MRIO network including larger (and more functionally defined) economies avoids the common mistake of building too-small single-region models. Finally, MRIO multipliers clearly illustrate the incremental feedbacks of each linked model to the obvious advantage of a user attempting to explain the spatial distribution of impacts.

As a final conjectural issue, consider the following. If a nation-wide MRIO multiplier model with county-level granularity was available, why would one want to use a single-region model for impact analysis? Let's explore this question a bit together.

SATURDAY, June 5
10:45 A.M. - 12:15 P.M.

MCRSA SESSION 6A: CITY PLANNING

- MILLS STUDIO 3
4TH FLOOR

Chair: David Sorenson

Community Strategic Visioning Programs: Approaches and Outcomes

Author(s):

Norman Walzer, Northern Illinois University (*presenting*)

Top Sudhipongpracha, Northern Illinois University (*non-attending*)

Lines in the Sand; Lines on the Map

Group Formation and the Fragmenting of Urban Local Government

Author(s):

Matthew Howell, University of Kentucky (*presenting*)

Discussants:

Richard Cebula

Sara Kaplan

Sarah Markenson

SATURDAY, June 5
10:45 A.M. - 12:15 P.M.

MCRSA SESSION 6B: PRODUCTION FUNCTION II
- MILLS STUDIO 2
4TH FLOOR

Chair: John Lehman

Which Ambitions of Growth do Female Entrepreneurs Have?

Author(s):

Britt Paula Morkved, Nord-Trondelag University College, Norway (*presenting*)

Market Power of the Japanese Non-GM soybean Import Market

Author(s):

Koichi Yamaura, Kansas State University (*presenting*)

Do Retailers Exercise Market Power? The Case of Milk

Author(s):

Vardges Hovhannisyan, University of Wisconsin-Madison (*presenting*)

Kyle Stiegert, University of Wisconsin-Madison (*non-attending*)

Discussants:

John Lehman

David Hoppock

Hans Siggaard Jensen

SATURDAY, June 5
10:45 A.M. - 12:15 P.M.

MCRSA SESSION 6C: POLICY

- MILLS STUDIO 1
4TH FLOOR

Chair: David Marcouiller

Benefit Cost, Per Unit, and Impact Analysis of Potential Water Saved From the Biological Control of Arundo Donax Along the Rio Grande River

Author(s):

Emily Kaye Seawright, Texas AgriLife Research (*presenting*)
M.Edward Rister, Texas A&M University (*non-attending*)
Ronald Lacewell, Texas A&M University (*non-attending*)
Dean McCorkle, Texas AgriLife Extension (*non-attending*)
Allen Sturdivant, Texas A&M University (*non-attending*)
John Goolsby, U.S. Department of Agriculture (*non-attending*)
Chenghai Yang, U.S. Department of Agriculture (*non-attending*)

Institutions of the Underground Rain: Commons Governance on the Ogallala Aquifer

Author(s):

Charles Franklin, Washington University St. Louis (*presenting*)

Urban Bias in Rural Poverty and Inequality: A Case Study of India

Author(s):

Shahriar Kibriya, Texas A&M University (*presenting*)

Discussants:

David Marcouiller
Kim Jensen
Britt Paula Morkved

SATURDAY, June 5
10:45 P.M. – 12:15 P.M

IMPLAN SESSION 6D: ECONOMIC MODELING

– MILLS STUDIO 4
4TH FLOOR

Comparison of Local economic Models, REMI, IMPLAN, and Southern California Inter-County Social Account Matrix (SCI-SAM): Impact Analysis on LA-LB Dual Ports Disruption

Author(s):

JiYoung Park, University at Buffalo (*presenting*)

Simon Choi, Southern California Association of Governments (*attending*)

ChangKeun Park, University of Georgia (*non-attending*)

Business Employment Dynamics Analysis

Author(s):

Sherry Konigsberg, Bureau of Labor Statistics (*presenting*)

Carol Leming, Bureau of Labor Statistics (*non-attending*)

The Job Openings and Labor Turnover Survey: Boom and Bust Counties

Author(s):

Masanori Shirako, Bureau of Labor Statistics (*presenting*)

Mike McCall, Bureau of Labor Statistics (*non-attending*)

SATURDAY, June 5
10:45 P.M. – 12:15 P.M

IMPLAN SESSION 6E: ECONOMIC RELATIONSHIPS
– MILLS STUDIO 5
4TH FLOOR

How Can We Measure the Service Sectors' Contribution to Local Economies? A New Methodology with Oregon and Minnesota Examples

Author(s):

Bruce Sorte, Oregon State University (*non-attending*)
David Nelson, University of Minnesota Extension (*presenting*)
Brigid Tuck, University of Minnesota Extension (*attending*)
Michael Darger, University of Minnesota (*non-attending*)

Unplanned Land Development and Land Use Change in Southern California

Author(s):

Cheol-Ho Lee, Southern California Association of Governments (*presenting*)
Simon Choi, Southern California Association of Governments (*attending*)
Frank Wen, Southern California Association of Governments (*non-attending*)

The Economic Impact of Women Owned Businesses in the United States

Author(s):

Hassan Pordeli, Jacksonville University (*presenting*)
Peter Wynkoop, The HPW Group (*attending*)
Gwen Martin, Center for Women's Business Research (*non-attending*)

SATURDAY, June 5
12:15 P.M. – ADJOURN

SAFE TRAVELS!

CONFERENCE PARTICIPANTS

Brian Alstadt
Economic Development Research Group
2 Oliver Street, 9th Floor
Boston, MA 02109
617-338-6775 ext. 209
balstadt@edrgroup.com

Ambrose Alward
Minnesota IMPLAN Group, Inc.
708 Saint Croix Street N
North Hudson, WI 54016
970-412-3277
ambrose@implan.com

Greg Alward
Minnesota IMPLAN Group, Inc.
1725 Tower Drive West, Suite 140
Stillwater, MN 55082
651-439-4421
greg@implan.com

James Anderson
Michigan State University
968 Roxburgh Avenue
Wast Lansing, MI 48823
517-337-0241
anders90@msu.edu

Asleigh Arledge
University of Wisconsin-Madison
AAE, 427 Lorch Street
Madison, WI 53706
907-209-8386
arledge@wisc.edu

Ali Arshad
Optimum Equilibrium Solutions
3225 Calle Suenos
Rio Rancho, NM 87124
505-892-2694
arshad1984@aol.com

Hilal Atasoy
University of Illinois Urbana-Champaign
2005 Eagle Ridge Ct., Apt. A
Urbana, IL 61802
217-721-4518
hatasoy2@illinois.edu

Robert Ball
Tulsa Metro Chamber
2 West 2nd Street, Suite 150
Tulsa, OK 74103
918-560-0262
bobbball@tulsachamber.com

Clyde Barrow
Center for Policy Analysis
UMass Dartmouth
285 Old Westport Road
Dartmouth, MA 02747
cbarrow@umassd.edu

Holly Bender
Louis Berger Group
12596 W. Bayand Ave
Lakewood, CO 80228
33-985-6627
hbender@louisberger.com

Evan Bigos
Wilbur Smith Associates
3191 Maguire Blvd., Suite 200
Orlando, FL 32803
407-902-2726
ebigos@wilbursmith.com

David Borges
Center for Policy Analysis
UMass Dartmouth
285 Old Westport Road
Dartmouth, MA 02747
dborges@umassd.edu

David Buland
USDA - NRCS - CNTSC
501 W. Felix Street, Building 23
Fort Worth, TX 76115
817-509-3577
david.buland@ftw.usda.gov

Roger Butters
University of Nebraska-Lincoln
339 CBA
Lincoln, NE 68588
402-613-5132
rbutters@nebraskacouncil.org

CONFERENCE PARTICIPANTS

Mohamed Hanas Cader
Business and Economics Division
American University of Kuwait
P.O. Box 3323
Safat 13034, Kuwait
+965 224 8399 ext. 572
mcader@auk.edu.kw

Richard Cebula
Davis College of Business
Jacksonville University
Jacksonville, FL 32211
912-656-2997
dr.richardcebula@gmail.com

Wen-Huei Chang
U.S. Army Corp of Engineers
7701 Telegraph Road
Alexandria, VA 22315
Wen-Huei.Chang@usace.army.mil

Simon Choi
Southern California Association of
Governments
818 W. 7th Street, 12th Floor
Los Angeles, CA 90017
213-236-1849
choi@scag.ca.gov

Candi Clouse
Cleveland State University
1717 Euclid Avenue
Cleveland, OH 44111
216-687-2452
c.clouse@csuohio.edu

Kim Coffman
U.S. Minerals Management Service
381 Elden Street, MS-4010
Herndon, VA 20170
703-787-1221
kim.coffman@mms.gov

Jared Creason
U.S. EPA
1310 C Street
Washington, DC 20005
202-343-9273
creason.jared@epa.gov

Quint David
Appalachian State University
Research Institute for Environment, Energy,
and Economics
ASU Box 32131
Boone, NC 28608
828-719-8131
q5quint@gmail.com

Steve Deller
University of Wisconsin-Madison
515 Taylor Hall
427 Lorch St.
Madison, WI 53706
608-263-6251
scdeller@wisc.edu

Anna Denham
California Nurses Association
2000 Franklin Street
Oakland, CA 94612
510-273-2241
adenham@calnurses.org

Erika Dodd
Caesar Kleberg Wildlife Research Institute
Texas A&M University-Kingsville
4704 Penrose Avenue
Fort Worth, TX 76116
817-937-2555
epitzer@sbcglobal.net

Melinda Dontje
University of Minnesota Extension
1961 Premier Drive #110
Mankato, MN 56001
507-389-6714
dontj002@umn.edu

Rebekka Dudensing
Texas AgriLife Extension Service
467B Blocker Building
Texas A&M University 2124
College Station, TX 77843-2124
979-845-1719
rmdudensing@ag.tamu.edu

CONFERENCE PARTICIPANTS

John Eastwood
The W.A. Franke College of Business
Northern Arizona University
P.O. Box 15066
Flagstaff, AZ 86011
john.eastwood@nau.edu

Henry Eichman
USDA USFS TEAMS Enterprise
11 East 4th Street
Duluth, MN 55805
559-246-9723
henryeichman@fs.fed.us

Burton English
Department of Agricultural Economicsq
The University of Tennessee
308C Morgan Hall
2621 Morgan Circle
Knoxville, TN 37996
865-974-3716
benglish@utk.edu

Edward Evans
Tropical Research & Education Center
18905 SW 280th Street
Homestead, FL 33031
305-246-7001 ext. 272
eaevans@ufl.edu

Charles Franklin
Washington University in St. Louis
7338 Forsyth Blvd.
Apt 106
St. Louis, MO 63105
847-903-1287
cfranklin@wustl.edu

Shriniwas Gautam
University of Missouri-Columbia
601 S. Providence Rd, 705 H
Columbia, MO 65203
573-771-0387
sgm8f@mail.missouri.edu

Elizabeth Gibson
University of Texas-El Paso
500 W. University
El Paso, TX 79968
915-747-8853
ekgibson@utep.edu

Kjell Age Gotvassli
Nord-Trondelag University College
Kungens GT 42
N-7729 Steinkjer
+47 97546193
kjell.gotvassli@hint.no

Bridget Guerrero
Texas Agrilife Extension Service
Box 42132
Lubbock, TX 79409
806-742-1921 ext 246
blguerrero@ag.tamu.edu

Ronald Gunderson
Department of Economics
Northern Arizona University
FCB Box 15066
Flagstaff, AZ 86011
928-523-7358
Ronald.Gunderson@nau.edu

Karin Hagaman
St. Louis Development Corporation

Gisele Hamm
Illinois Institute for Rural Affairs
Western Illinois Univeristy
524 Stipes Hall
1 University Circle
Macomb, IL 61455
309-298-4019
gf-hamm@wiu.edu

CONFERENCE PARTICIPANTS

Robin Hanna
Illinois Institute for Rural Affairs
Western Illinois University
318 Stipes Hall
One University Circle
Macomb, IL 61455
800-526-9943
RW-Hanna@wiu.edu

Kenneth Hanson
USDA Economic Research Service
1800 M Street NW, Suite N-2176
Washington, DC 20036
202-694-5427
khanson@ers.usda.gov

Brian Harger
Center for Governmental Studies
Northern Illinois University
148 North Third Street
DeKalb, IL 60115
815-753-0934
bharger@niu.edu

Kingsley Haynes
School of Public Policy
George Mason University
4400 University Drive, MSN 3C6
Fairfax, VA 22030
703-993-4108
khaynes@gmu.edu

Beth Walter Honadle
Department of Political Science
University of Cincinnati
1110 Crosley Tower
P.O. Box 210375
Cincinnati, OH 45221
513-556-2303
beth.honadle@uc.edu

David Hoppock
Duke University
Climate Change Policy Partnership
Box 90658
Durham, North Carolina 27708
919-681-9711
david.hoppock@duke.edu

Vardges Hovhannisyan
Department of Agricultural and Applied
Economics
University of Wisconsin-Madison
17 Lorch Street
Taylor Hall
Madison, WI 53706
608-262-7359
hovhannisyan@wisc.edu

Matthew Howell
University of Kentucky
415 Patterson Office Tower
Lexington, KY 40506
859-327-1221
MatthewLHowell@uky.edu

Anwar Hussain
Forestry Department
Mississippi State University
775 Stone Blvd.
110 Thompson Hall
Mississippi State, MS 39762
662-325-4259
ahussain@cfr.msstate.edu

Angannette Jackson
Federal Aviation Administration
800 Independence Avenue
Portal Building, Office 3116, 3rd Floor
Washington, DC 20591
202-385-7217
angannette.jackson@faa.gov

Hans Siggaard Jensen
Aarhus University, DPU
Tuborgvej 164
DK 2400 Copenhagen NV, Denmark
+45 40414593
hsj@dpu.dk

Kim Jensen
Department of Ag. and Resource Economics
The University of Tennessee
308 Morgan Hall
Knoxville, TN 37996
865-974-3716
kjensen@utk.edu

CONFERENCE PARTICIPANTS

Daniel Johnston
Institute for Health & Socio-Economic
Policy
Oakland, CA
510-273-2200
dan@ihsp.org

Elizabeth Johnston
ICF International
33 Hayden Avenue, Third Floor
Lexington, MA 02421
781-676-4087
ejohnston@icfi.com

Aloyce Kaliba
Southern University and A&M College
P.O. Box 9723
Baton Rouge, LA 70813
225-771-2992 ext 237
aloyce_kaliba@subr.edu

Sung Hoon Kang
Department of Agriculture, Food, and
Resource Economics
Michigan State University
208 Cook Hall
East Lansing, MI 48824
kangsun6@msu.edu

Sara Kaplan
Iowa State University
403 East Hall
Ames, IA 50011
sarak@iastate.edu

Russ Kashian
Economics Department
University of Wisconsin-Whitewater
4404 Hyland Hall
Whitewater, WI 53190
262-472-5584
kashianr@uww.edu

Steven Keenan
Springfield-Sangamon County Regional
Planning Commission
200 South Nine Street, Suite 212
Springfield, IL 62701
217-535-3110
SteveK@co.sangamon.il.us

Stanley Keil
Department of Economics
Ball State University
Whitinger Business Building, Room 201
2000 West University Avenue
Muncie, IN 47306
765-285-5364
skeil@bsu.edu

Viktor Khanzhyn
Department of Economics
University of Nebraska-Lincoln
347 College of Business Administration
Building
Lincoln, NE 68588
42-326-8715
vkhanzhyn@yahoo.com

Shahriar Kibriya
Texas A&M University
1100 Hensel Drive
Apt X1D
College Station, TX 77840
979-204-7890
srkibriya@ag.tamu.edu

Arne Kildengaard
Department of Economics and Management
University of Minnesota-Morris
Camden 202
Morris, MN 56267
320-589-6190
kildegac@morris.umn.edu

CONFERENCE PARTICIPANTS

Sherry Konigsberg
Bureau of Labor Statistics
2 Massachusetts Avenue NE, Room 4840
Washington, DC 20212
202-691-7626
konigsberg.sheryl@bls.gov

Bill Lazarus
wlazarus@umn.edu

John Leatherman
Department of Agricultural Economics
Kansas State University
331G Waters Hall
Manhattan, KS 66506
785-532-4492
jleather@agecon.ksu.edu

Cheol-Ho Lee
Southern California Association of
Governments
818 W. 7th Street, 12th Floor
Los Angeles, CA 90017
213-236-1848
leec@scag.ca.gov

John Lehman
Appalachian State University
Research Institute for Environment, Energy,
and Economics
ASU Box 32131
Boone, NC 28608
610-247-7511
lehmanjg@appstate.edu

Scott Lindall
Minnesota IMPLAN Group, Inc.
1725 Tower Drive West, Suite 140
Stillwater, MN 55082
651-439-4421
scott@implan.com

Brian London
Visit Florida
2540 West Executive Center Circle, Suite 200
Tallahassee, FL 32301
850-205-3826
blondon@visitflorida.org

Eric Long
Greater Oklahoma City Chamber
123 Park Avenue
Oklahoma City, OK 73102
405-297-8976
elong@okcchamber.com

Aaron Lusby
Department of Agricultural Sciences
Louisiana Tech University
Louisiana Tech Rural Development Center
P.O. Box 10198
Ruston, LA 71272
318-257-2451
alusby@latech.edu

Eric Manthei
Texas A&M University
467C Blocker Building
College Station, TX 77843
979-845-1705
ewmanthei@ag.tamu.edu

Dave Marcouiller
Department of Urban and Regional
Planning
University of Wisconsin-Madison
101 Old Music Hall
925 Bascom Mall
Madison, WI 53901
608-262-2997
dwmarcou@wisc.edu

Sarah Markenson
Saint Louis University
7510 Devonshire Avenue
St. Louis, Missouri 63119
573-230-1786
smarkenson1@gmail.com

Bjorn Markeson
University of Wisconsin-Madison
6832 Schroeder Road
Apt 10
Madison, WI 53711
763-244-0776
bmarkeson@wisc.edu

CONFERENCE PARTICIPANTS

Anikka Martin
University of Illinois
1905 N. Cunningham
Apt 207D
Urbana, IL 61802
785-626-4271
marti137@illinois.edu

Andrea Mason
Iowa State University
918 NE 53 CT
Ankeny, IA 50021
712-229-7927
amason@iastate.edu

Eric McClellan
Wilbur Smith Associates
1301 Gervais Street, 13th Floor
Columbia, SC 29201
803-251-2186
emcclellan@wilbursmith.com

Jamey Menard
University of Tennessee
302 Morgan Hall
2621 Morgan Circle
Knoxville, TN 37996
865-974-3716
rmenard@utk.edu

Joshua Miller
Department of Economics
University of Illinois at Chicago
jmille3@uic.edu

Bhawani Mishra
University of Missouri-Columbia
601 S. Providence Road, Apt 603i
Columbia, MO 65203
573-882-7863
bpm42c@mail.missouri.edu

Scott Moore
Moore Data, LLC
4787 Marshwood Drive
Hollywood, SC 29449
843-564-5257
scott.moore@connectmooredata.com

Britt Paula Morkved
Faculty of Economics
Nord-Trondelag University College,
Norway
Kongens GT 42
7729 Steinkjer, Norway
+47 91606033
britt.p.morkved@hint.no

Jessica Moroz
Economic Development Council for Central
Illinois
100 SW Water Street
Peoria, IL 61602
309-495-5956
jmoroz@edc.h-p.org

Ian Munn
Mississippi State University
775 Stone Blvd
Mississippi State, MS 39762
662-325-4546
imunn@cfr.msstate.edu

Albert Myles
Department of Agricultural Economics
Mississippi State University
P.O. Box 5187
Mississippi State, MS 39762
662-325-1749
myles@agecon.msstate.edu

David Nelson
Community Economics Educator
Extension Regional Office, Mankato
1961 Premier Drive, #110
Mankato, MN 56001
507-389-6660
nelso417@umn.edu

Inder Pal Nijhawan
Fayetteville State University
3545 Turnberry Circle
Fayetteville, NC 28303
910-864-0351
Inijhawan@uncfsu.edu

CONFERENCE PARTICIPANTS

Susan Ockert
Montana Department of Commerce/CEIC
301 S. Park Avenue
P.O. Box 200505
Helena, MT 59620
406-841-2740
sockert@mt.gov

Peter Ogonowski
Wilbur Smith Associates
3191 Maguire Blvd., Suite 200
Orlando, FL 32803
407-902-2706
pogonowski@wilbursmith.com

JiYoung Park
School of Architecture and Planning
University at Buffalo
The State University of New York
201F Hayes Hall
Buffalo, NY 14214
716-829-3485 ext. 209
jp292@buffalo.edu

Hassan Pordeli
Davis College of Business
Jacksonville University
Jacksonville, FL 32211
904-256-7450
hpordel@ju.edu

Doug Rasmussen
St. Louis County Economic Council

Michael Retzlaff
Economic Insights of Colorado, LLC
7924 Eagle Feather Way
Lone Tree, CO 80124
303-768-0368
eic@comcast.net

Marty Romitti
Director of MERIC
MO Department of Economic Development
- MERIC
301 W High Street
HST Building, Room 580
Jefferson City, MO 65101
573-751-3672
Joyce.becker@ded.mo.gov

Jim Rossi
University of Missouri
2305 Topaz Drive
Columbia, MO 65203
573-446-0843
jdr5gd@mail.missouri.edu

David Schoen
Center for Business and Economic Research
Ball State University
WB 149
Muncie, IN 47306
dschoen@bsu.edu

Emily Kaye Seawright
Texas AgriLife Research
2124 TAMU
College Station, TX 77843
979-845-2334
ekseawright@ag.tamu.edu

Dale Shannon
CERC, Inc.
805 Brook Street, Building 4
Rocky Hill, CT 06067
860-571-6209
dshannon@cerc.com

Ruth Sergenian
St. Louis Regional Chamber and Growth
Corporation

Dave Shideler
Agricultural Economics
Oklahoma State University
323 Ag Hall
Stillwater, OK 74078
405-744-6170
dave.shideler@okstate.edu

CONFERENCE PARTICIPANTS

Masanori Shirako
Bureau of Labor Statistics
2 Massachusetts Avenue
Washington, DC 20212
202-691-6489
shirako.masa@bls.gov

Mark Skidmore
Michigan State University
6019 Elise Road
Bath, MI 48808
920-650-2295
mskidmor@anr.msu.edu

Thomas Smith
TR Smith and Associates
9898 Lakeview Circle
Strongsville, OH 44136
440-846-8791
tsmith5632@wowway.com

Timothy Solomon
Regional Development Alliance, Inc.
P.O. Box 473
Ucon, ID 63454
208-528-9400 ext. 238
tim@rdaidaho.org

David Sorenson
Augustana College
2001 S. Summit Avenue
Sioux Falls, SD 57197
605-274-5223
david.sorenson@augie.edu

Alan Spell
Economic Workforce Research Manager
MO Department of Economic Development
- MERIC
301 W. High Street
HST Building, Room 580
Jefferson City, MO 65101
573-751-3672
joyce.becker@ded.mo.gov

Cheryl St.Clair
National Center for Rural Health Works
Oklahoma State University
513 Ag Hall
Stillwater, OK 74078
405-744-6083
cheryl@okstate.edu

Jack K. Strauss
Simon Center for Regional Forecasting
St. Louis University

Randall Stufen
Stuefen Research, LLC
813 Valley View Drive
Vermillion, SD 57069
605-624-9754
randall@stuefenresearch.com

Timothy Sullivan
Department of Economics and Finance
Southern Illinois University-Edwardsville
Edwardsville, IL 62026
618-650-3469
tsulliv@siue.edu

Nalitra Thaiprasert
Center for Business and Economic Research
Ball State University
WB 149
Muncie, IN 47306
765-285-1613
nthaiprasert@bsu.edu

Eric Thompson
University of Nebraska-Lincoln
1270 R Street
Lincoln, NE 68588
402-472-3318
ethompson2@unl.edu

James Thorson
Department of Economics and Finance
Southern Connecticut State University
501 Crescent Street
New Haven, CT 06515
203-392-5626
thorsonj1@southernct.edu

CONFERENCE PARTICIPANTS

Roberto Tinajero
University of Texas-El Paso
500 W University
El Paso, TX 79968
915-747-5096
rtinajero@utep.edu

Thomas Treiman
Missouri Department of Conservation
1110 S. College Avenue
Columbia, MO 65043
573-882-9909 ext. 3308
tom.treiman@mdc.mo.gov

Brigid Tuck
University of Minnesota Extension
1961 Premier Drive, Suite 110
Mankato, MN 56001
507-389-6979
tuckb@umn.edu

Ragnhild Vada
Nord-Trondelag University College,
Norway
Heggelivn 15 C
7725 Steinkjer, Norway
ragnhild.vada@hint.no

Steve Vickner
OutdoorMetrics
59 Saint Stephens Ct
Gahanna, OH 43230
614-551-1916
stehevickner@gmail.com

Norman Walzer
Center for Governmental Studies
Northern Illinois University
Regional Development Institute
148 North 3rd Street
DeKalb, IL 60115
815-753-0933
nwalzer@niu.edu

Knut Ingar Westernen
Nord-Trondelag University College,
Norway
Kongens GT 42
7729 Steinkjer, Norway
+47 90134994
knut.i.westeren@hint.no

Melissa Whited
University of Wisconsin-Madison
412 S. Brearly #2
Madison, WI 53703
617-233-9643
mwhited@wisc.edu

Peter Wynkoop
The HPW Group
2325 Seminal Road
Atlantic Beach, FL 32233
904-662-7261
thehpwgroup@earthlink.net

Koichi Yamaura
Department of Agricultural Economics
Kansas State University
342 Waters Hall
Manhattan, KS 66506
785-532-6702
kyamaura@agecon.ksu.edu

Yue Zheng
Department of Agricultural Economics
Kansas State University
342 Waters Hall
Manhattan, KS 66502
YueZheng@agecon.ksu.edu



Hyatt Regency St. Louis at The Arch

DIRECTIONS

By car from Lambert Field International Airport (15 miles): Take I-70 East to Memorial Drive exit. Go straight on Memorial Drive. Turn right onto Market Street. Turn right onto North 4th Street. Turn right onto Chestnut Street – hotel on left.

SECOND FLOOR

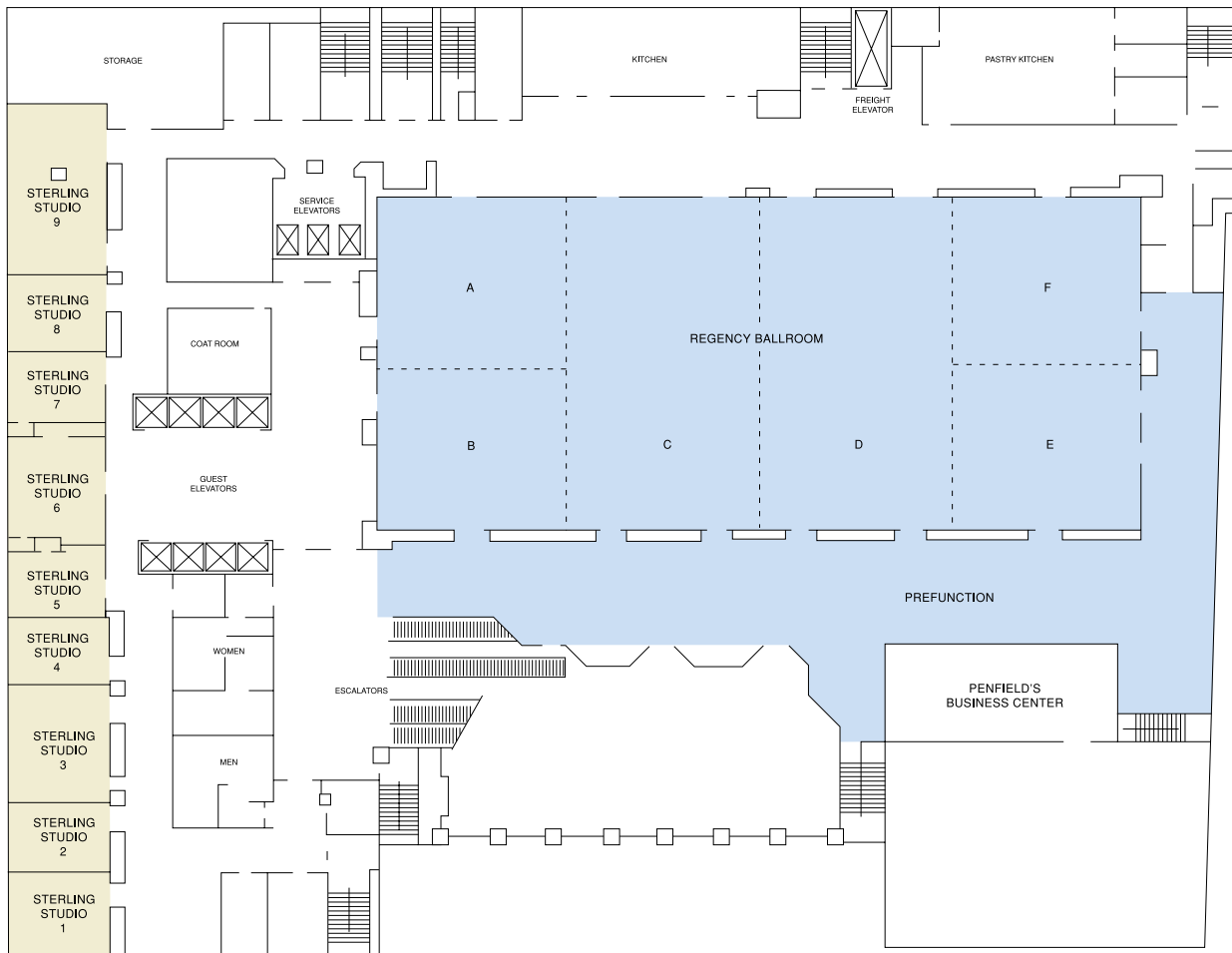

Hyatt Regency St. Louis at The Arch

FLOORPLAN

FOURTH FLOOR

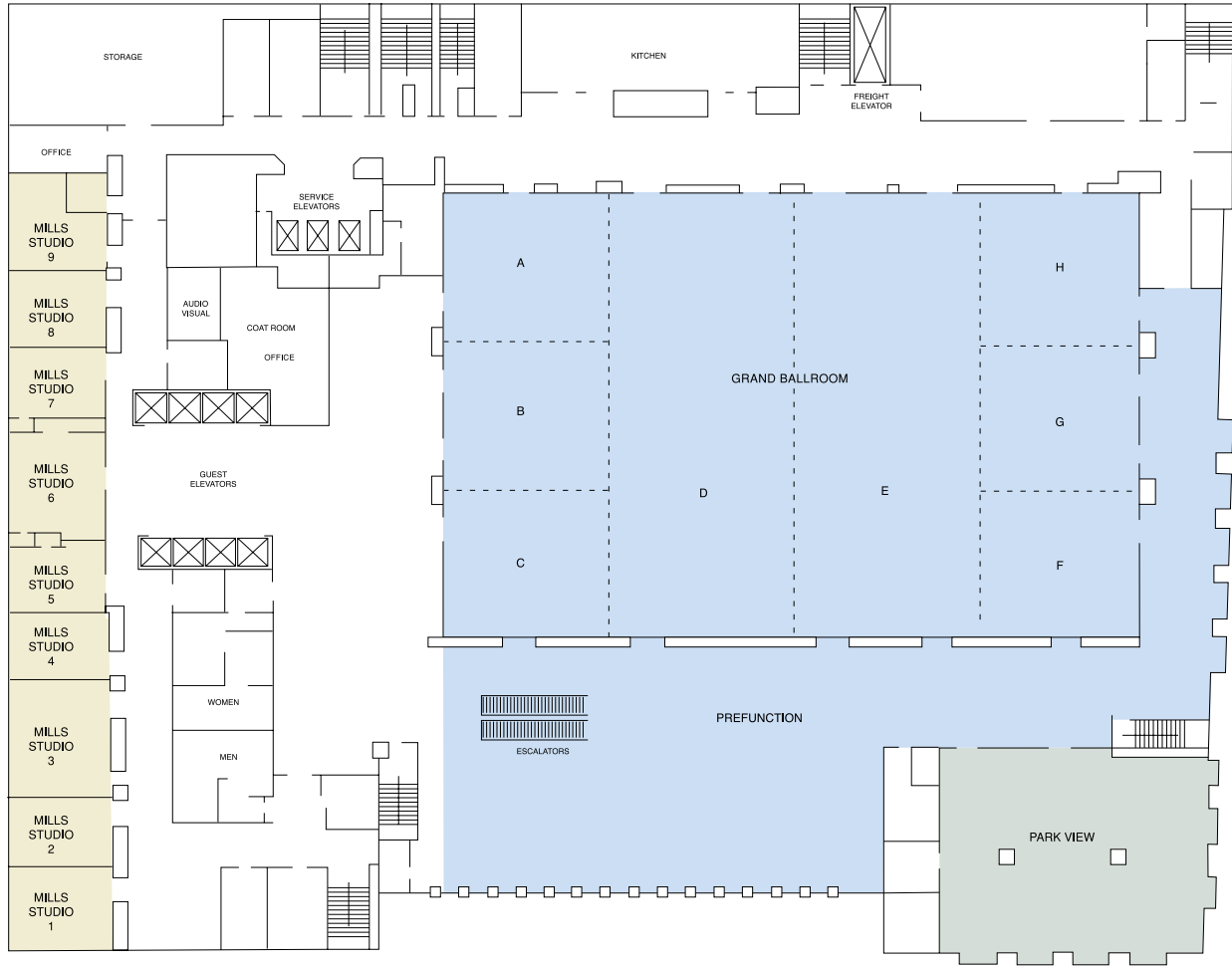

Hyatt Regency St. Louis at The Arch

FLOORPLAN

EIGHTEENTH FLOOR

ST. LOUIS ARCH ►

